

INVESTING IN THE ENERGY TRANSITION BY LAKSANA



LAKSANA'S MISSION:

**FOR INDONESIA TO BE ABLE
TO DESIGN AND PRODUCE
ITS OWN VEHICLE
AT HIGH QUALITY STANDARD**

1500 buses
production capacity /year



HALF A DECADE INVESTMENT IN BUS INDUSTRY

*Investing in a network of
supporting industries*

more than

200

vendors & supplier to Laksana

more than

10.000

people directly involved

1.200.000

workers in carroserry industry

(based on BPS 2023)

LAKSANA DEVELOPMENT OF HIGHLY DURABLE AND LIGHTWEIGHT E-BUS DESIGN

- *First in Indonesia the use of high strength stainless steel frame design*
- *Overall weight reduction 1,4tons (for 12m bus)*
- *First bus introduced in 2019, tested & evaluated*



Citybus basic on ICE

Electric Citybus



Cityline3 HD - BYD



Cityline3 LD - BYD



Cityline3 HD - Hyundai

LAKSANA FUTURE INVESTMENT

For Energy Sustainable Bus & Coach

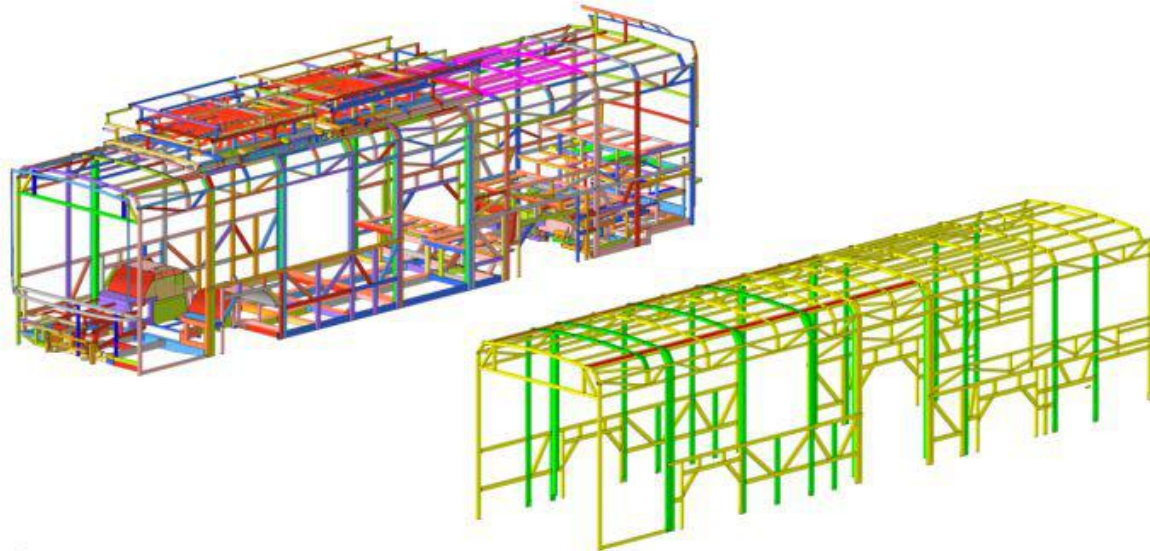

**Future collaboration with e-chassis producers
FEA Simulation and Actual Endurance Test



EXPANSION FOR EV-BUS Assembly Line



ELECTRIC BUS **Challenges & Solutions** **in Indonesia**

Demand
uncertainties

Long
procurement
processes
without delivery time adjustment

ELECTRIC BUS *Challenges & Solutions in Indonesia*



hi deck, tourism need

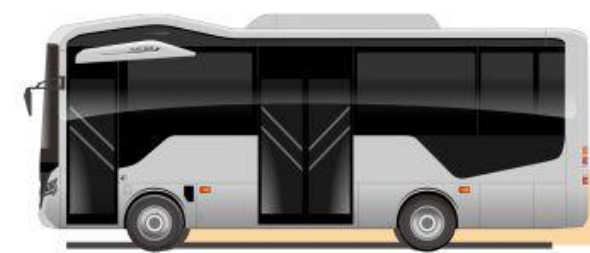

front & mid door

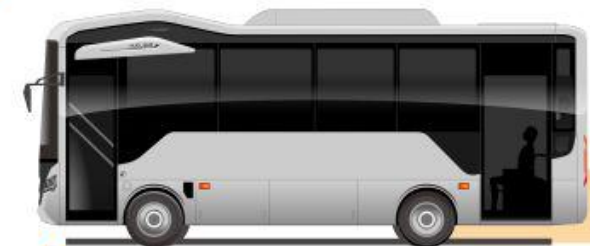

front & rear door , dissable friendly



front & rear door



front & rear door (high entry)

Indonesia's diverse bus needs

VARIOUS TYPES OF BODY MODEL,
DEPEND ON THE FUNCTION

ELECTRIC BUS

Challenges & Solutions

in Indonesia

REGULATION

OF IMPORT TARIFF

IMPORT DUTY TARIFF COMPARISSON - ELECTRIC VEHICLES - YEAR 2023									
KIND OF VEHICLE	TYPE	HS CODE	IMPORT DUTY TARIFF				PPN TARIFF	PPH TARIFF	PPNBM TARIFF
			MFN	KOREA	CHINA	JAPAN			
				AKFTA	ACFTA	IJEPA			
EV BUS	CBU	8702.40.79	50%	0%	5%	0%	11%	7,5%	0%
	CKD	8702.40.29	10%	0%	5%	0%	11%	2,5%	0%
	BARE CHASSIS	8706.00.22	40%	5%	40%	0%	11%	2,5%	0%
EV TRUCK	CBU (GVW : 1-5 Ton)	8704.60.29	50%	5%	40%	5%	11%	7,5%	0%
	CBU (GVW : 5-10 Ton)	8704.60.91	50%	5%	40%	0%	11%	7,5%	0%
	CBU (GVW : 10-20 Ton)	8704.60.92	50%	5%	40%	0%	11%	7,5%	0%
	CBU (GVW : 20-45 Ton)	8704.60.93	50%	5%	40%	0%	11%	7,5%	0%
	CBU (GVW > 45 Ton)	8704.60.94	50%	5%	40%	0%	11%	7,5%	0%
	CKD	8704.60.19	10%	0%	20%	0%	11%	2,5%	0%
	BARE CHASSIS (GVW < 24 Ton)	8706.00.41	40%	5%	40%	0%	11%	2,5%	0%
	BARE CHASSIS (GVW > 24 Ton)	8706.00.42	10%	5%	10%	0%	11%	2,5%	0%
MINIBUS	CBU	8703.80.98	50%	5%	50%	0%	11%	10%	0%
	CKD	8703.80.18	10%	0%	20%	0%	11%	2,5%	0%
BATTERY CHARGER		8504.40.90	10%	0%	0%	0%	11%	2,5%	0%

LAKSANA'S **PRODUCT LINE UP**





LAKSANA